

# Embrague / Clutch

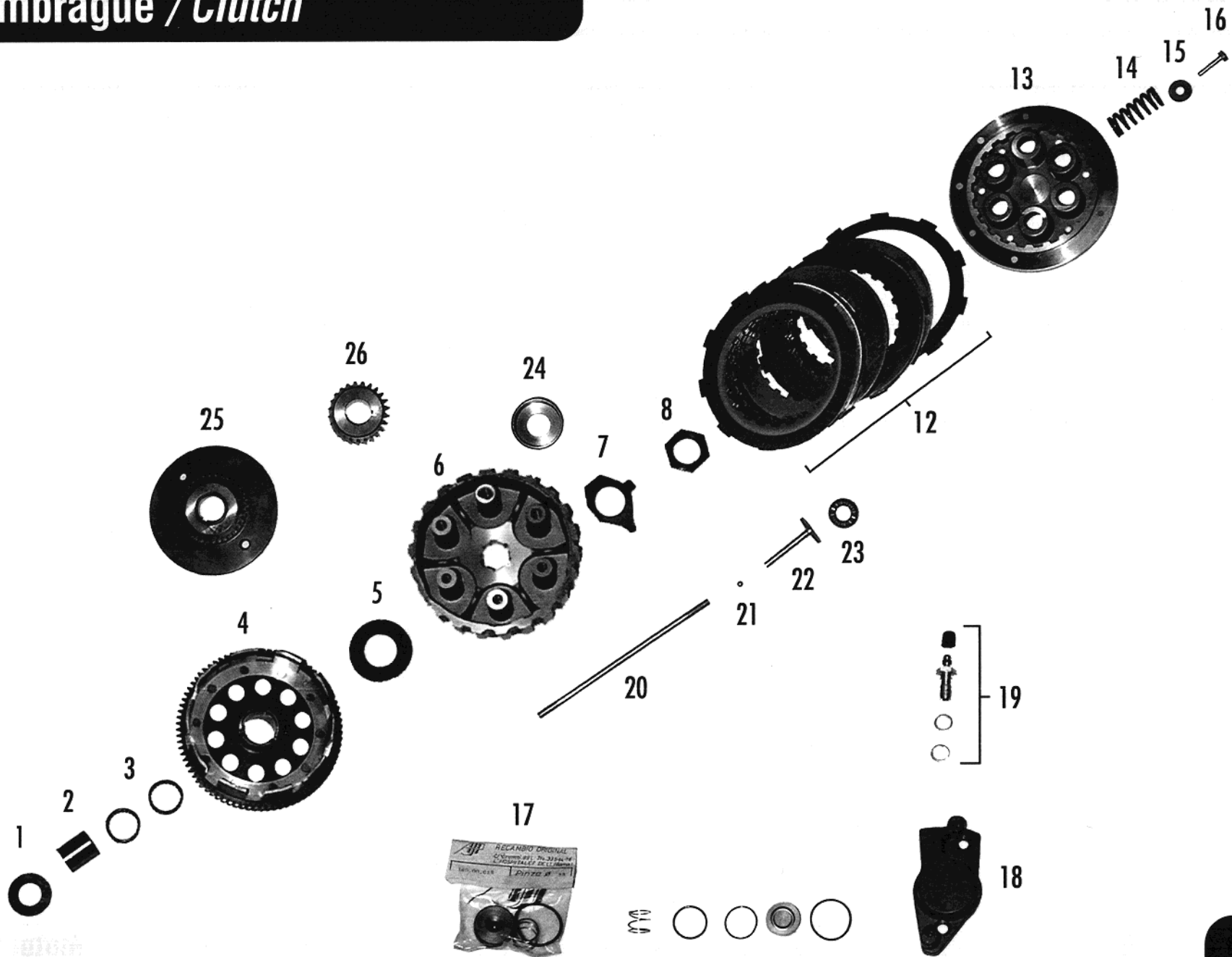

Nº	DESCRIPCION	280cc.	125cc.	200cc.	249cc.	321cc.	Cant.
1	Arandela 20.15x38x3.25 / Washer cover	M03226000					1
2	Casquillo embrague 20x26x28.6 / Pivot, bush clutch	M03224000					1
3	Cojinete agujas K26-30-13 / Bearing needles	M03225000					2
4	Corona embrague / Helical gear set assy	M03210002					1
5	Arandela intermedio 17.5x34x1 / Washer intermediate	M03223000					1
6	Cubo embrague 98 / Hub, clutch	MT27832005					1
7	Arandela fijación cubo / washer lock hub		M03222001	M03222001			1
8	Tuerca fijación cubo bal.piñon / Nut fij. Hub bal. pinion	M03221000					1
12	Cto.discos embrague 98 / Cpt. clutch disk	MT27732050					1
13	Plato embrague 98 / Clutch plate	MT27832006					1
14	Muelle embrague / Clutch spring	M03216002					6
15	Arandela muelle emb. 17x5x1.5 / Washer clutch spring	M03218001					6
16	Hexagonal 5x20 (12.9) DIN 933 / Hexagonal	T0105020					6
17	Kit pinza embrague hidr. / Kit caliper clutch hydraulic	M01059000					1
18	Pinza embrague hidráulico / Caliper clutch hydraulic	M01050000					1
19	Racord pinza embrague hidrau. / Bleed screw, union bolt	M01060000					1
20	Varilla embrague hidráulico / Push rod clutch hydraulic	M03228002					1
21	Bola varilla embrague 5mm / Ball bearing clutch	M03235001					1
22	Bolet varilla embrague / Mushroom adjuster clutch	M03233000					1
23	Coj.prensa embrague AX1022 / Bearing clutch end plate	M03234001					1
24	Casq. Cent. prensa embr. / Bushing centralize clutch press	MT27832052			MT27832052	MT27832052	1
25	Piñón contrapeso / Counterweight pinion	M03210000					1
26	Piñón transmisión primaria / Transmission primary pinion	M03210001					1